

ONE STAIR RAIL - M8R1R (AS SHOWN) <sup>△</sup>  
 ONE STAIR RAIL - M8R1L (OPP HAND)

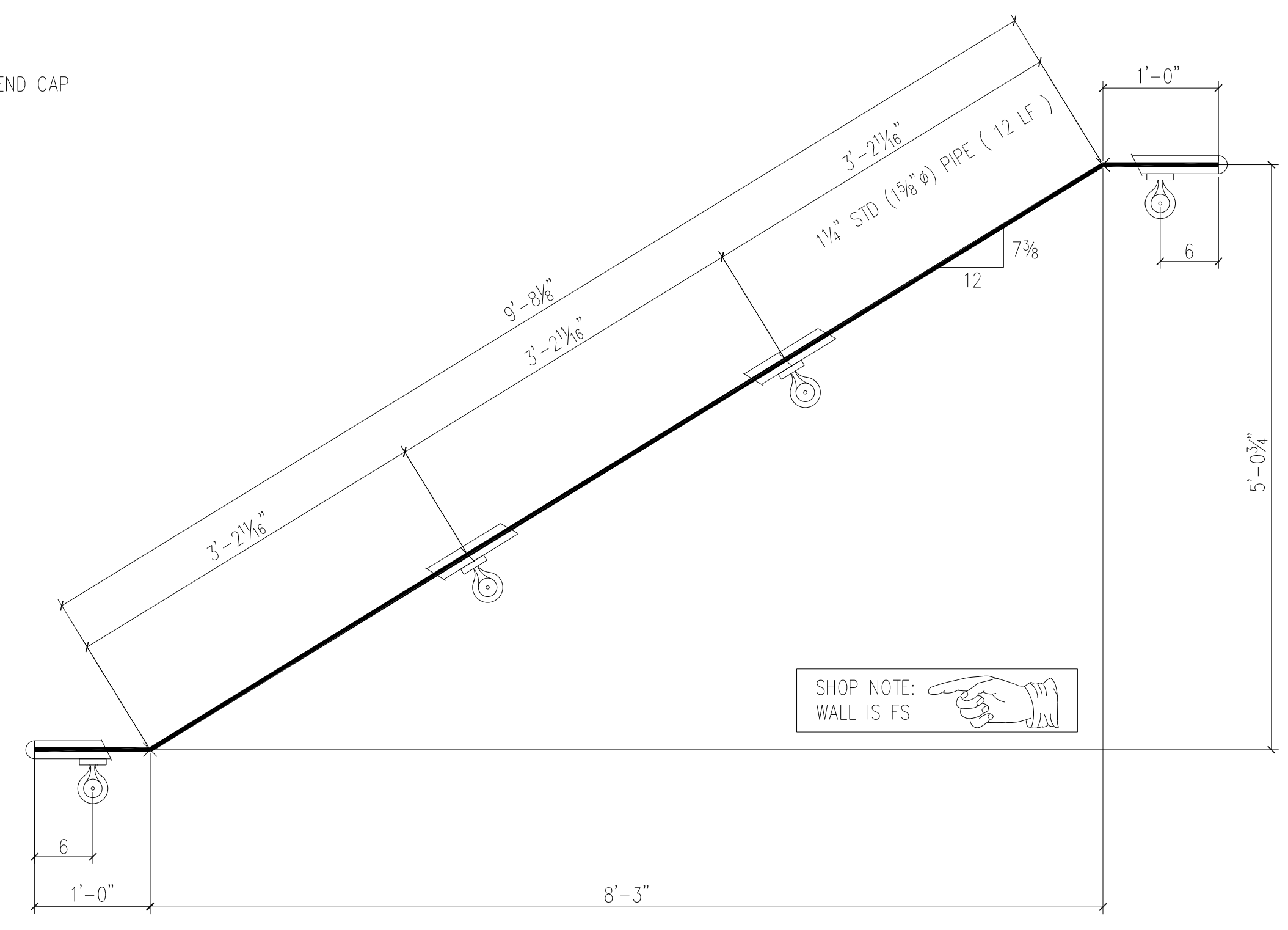

ONE WALL RAIL - M8R3R (AS SHOWN)  
 ONE WALL RAIL - M8R3L (OPP HAND)

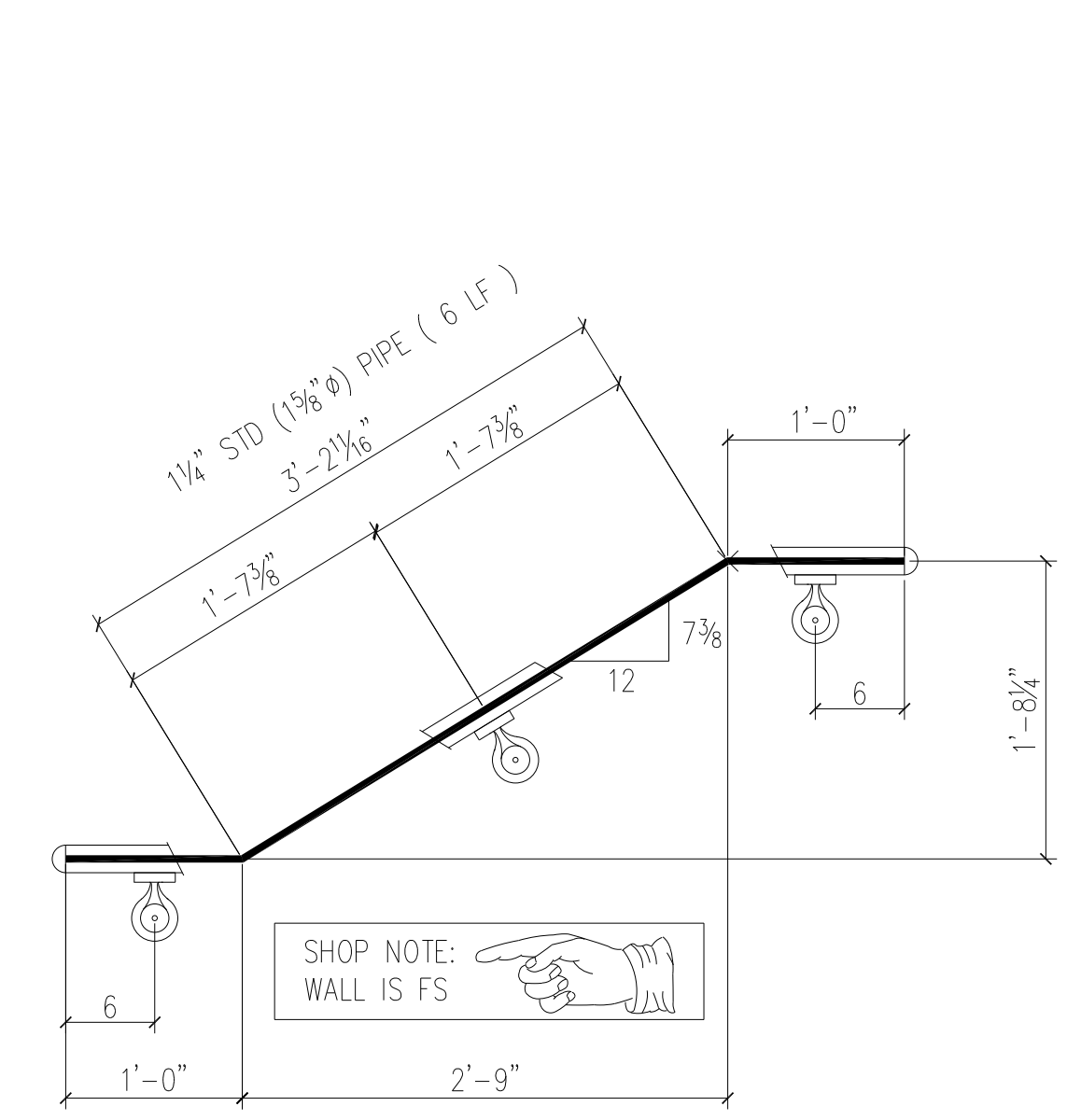

ONE WALL RAIL - M8R2R (AS SHOWN)  
 ONE WALL RAIL - M8R2L (OPP HAND)

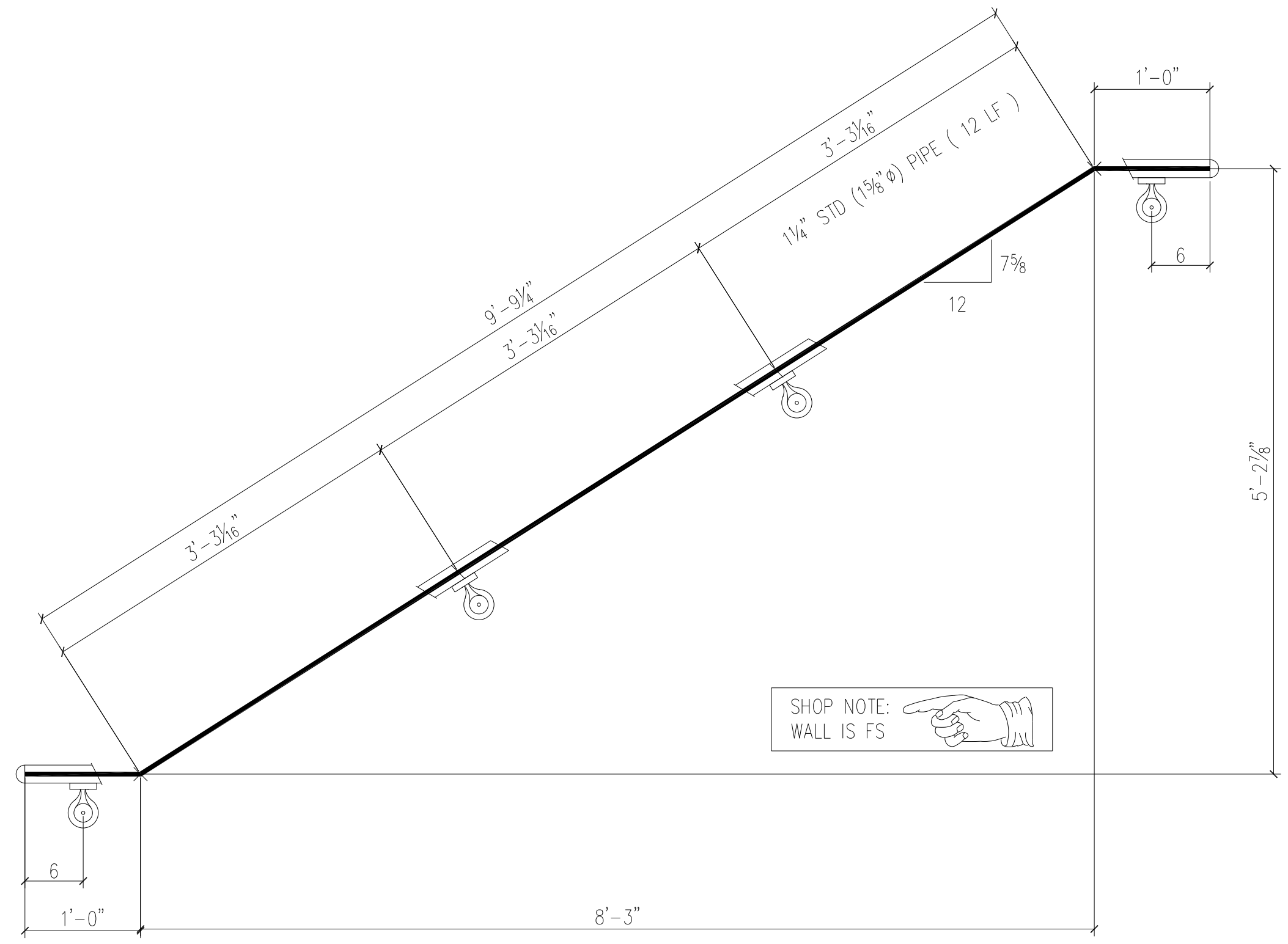

(4) WALL RAIL - M8R4R (AS SHOWN)  
 (4) WALL RAIL - M8R4L (OPP HAND)

SHOP BILL

SHIP MK	PC MK	QTY	DESCRIPTION	FT	IN	REMARKS	WEIGHT
M8R1R/L	ONE/ONE		STAIR RAIL				
		32	1 1/4" STD PIPE				74.00
		10	STD WALL BRACKET				
		4	STD PIPE END CAP				
			TOTAL WEIGHT				74.00
M8R2R/L	ONE/ONE		STAIR RAIL				28.00
		12	1 1/4" STD PIPE				
		6	STD WALL BRACKET				
		4	STD PIPE END CAP				
			TOTAL WEIGHT				28.00
M8R3R/L	ONE/ONE		STAIR RAIL				56.00
		24	1 1/4" STD PIPE				
		8	STD WALL BRACKET				
		4	STD PIPE END CAP				
			TOTAL WEIGHT				56.00
M8R4R/L	4/4		STAIR RAIL				56.00
		24	1 1/4" STD PIPE				
		8	STD WALL BRACKET				
		4	STD PIPE END CAP				
			TOTAL WEIGHT				56.00

VERIFY DIMENSION AND/OR DETAIL.

APPROVAL AUTHORITY:  
 VERIFICATION OF DIMENSIONS, DETAILS, ETC.  
 ARE REQUESTED WHERE INDICATED. IF EACH  
 VERIFICATION IS NOT NOTED OTHERWISE, IT  
 WILL BE ASSUMED TO BE CORRECT AS SHOWN.

THIS PROJECT SHALL BE ERRECTED PER THE AISC CODE OF STANDARD PRACTICE SPECIFICALLY PARAGRAPH 7.12 AS FOLLOWS:  
 7.12 CORRECTION OF ERRORS  
 NORMAL ERECTION OF OPERATIONS INCLUDE THE CORRECTION OF MINOR MISFITS BY MODERATE AMOUNTS OF REAMING, CHIPPING, WELDING OR CUTTING, AND THE DRAWING OF ELEMENTS INTO LINE THROUGH THE USE OF DRIFT PINS. ERRORS WHICH CANNOT BE CORRECTED BY THE FOREGOING MEANS OR WHICH REQUIRE MAJOR CHANGES IN MEMBER CONFIGURATIONS ARE TO BE REPORTED TO THE OWNER AND FABRICATOR BY THE ERECTOR, TO ENABLE WHOEVER IS RESPONSIBLE EITHER TO CORRECT THE ERROR OR TO APPROVE THE MOST EFFICIENT AND ECONOMIC METHOD OF CORRECTION TO BE USED BY OTHERS.  
 NO BACKCHARGES WILL BE ACCEPTED UNLESS APPROVED IN WRITING BY THIS OFFICE

REVISIONS	BY	DATE	DESCRIPTION
3			
2			
1	SRB	7-11	ELEV CHGS: ADD BOM

NOTES:

PAINT		ONE STD SC RIP	CUSTOMER
CLEANING			ENGR OR ARCH
MATERIAL GRADE		A36 (UNO)	CONSTANTINE ARCHITECTS
HOLES		1 3/16" U.N.O.	ENGR OR ARCH
			SHOP ORDER
			SHEET NO.
			REV

**E. Z. BREEZE**  
 253 SHERWOOD DRIVE  
 McMINNVILLE, TN. 37110

STRUCTURE: COUNTRY INN & SUITES  
 LOCATION: ORANGEBURG, SC  
 DETAIL: WALL RAILS

DATE: 7-11  
 CHECKER: SCL  
 DATE: 7-11

M8 1